



Jasper Flex

Compact High Power Femtosecond Fiber Laser

Femtosecond fiber lasers superior lifetime & performance

Jasper Flex – our high-power femtosecond laser for microprocessing. Its compact size makes it easy to use and to integrate. It delivers pulses with a maximum energy of 30 μJ , up to 1 MHz repetition rate. The user-configurable burst mode brings new capabilities in industries manufacturing consumer electronics, integrated photonics, and displays. Contrary to free-space lasers, our all-fiber, SESAM-free technology ensures unbeatable beam pointing stability resulting in an outstanding lifetime even in a harsh environment.

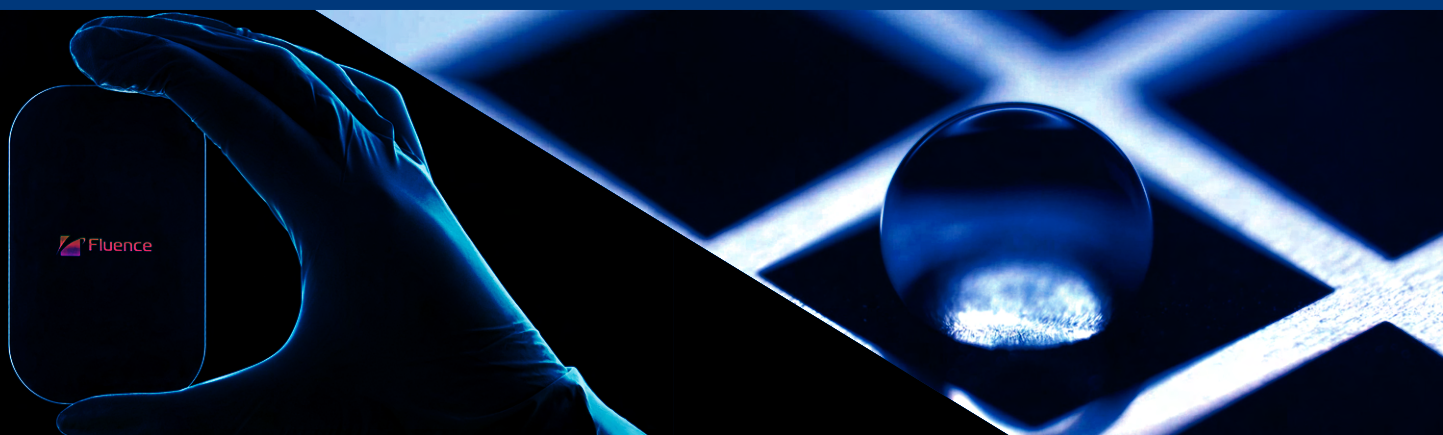

Technical specification:

Maximum average power	> 30 W @ 1030 nm (ask for higher)
Maximum pulse energy	> 30 μ J up to 1 MHz @ 1030 nm (ask for higher)
Base repetition rate	20 \pm 2.5 MHz
Two stage repetition rate tuning, selectable with control software	1 - 20 MHz, internal repetition rate Single Pulse - 1 MHz, realized with built-in pulse picker
Pulse duration	< 270 fs FWHM (< 250 fs typical)
Pulse duration tuning	< 270 fs - 8 ps, software-controlled (< 270 fs - 20 ps optional)
Wavelength	1030 \pm 5 nm
Optional wavelength outputs	With Harmonic Generation Module (HGM): 515 nm, 343 nm, 258 nm
Polarization	Linear, vertical
Beam quality M^2	< 1.3 (< 1.15 typical)
Output beam waist diameter $1/e^2$	2.0 \pm 0.5 mm (ask for other)
Burst mode for process enhancement	Included
6U, 19" rack-mountable chiller	Included
External gating trigger	Included
External analog power modulation	Included
Laser control software	Included
Pulse on demand	Included

Not exactly what you are looking for?
Get in touch with us and let us help you out.

Physical specification:

Size	646 (L) x 416 (W) x 111 (H) mm ³
Power supply unit size	3U rack: 485 (W) x 496 (D) x 133 (H) mm ³
Electrical	100 - 240 V AC, 50 - 60 Hz, < 300 W
Operating temperature	15 - 35°C
Operating humidity	Non-condensing
Chiller size	6U 19" rack unit: 485 (W) x 653 (D) x 267 (H) mm ³

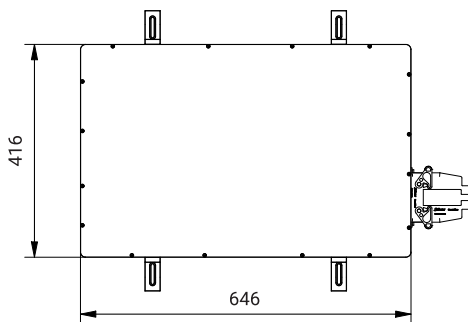
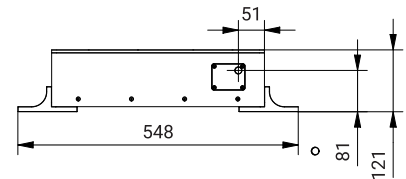
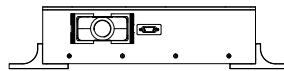
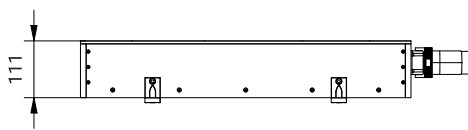

All dimensions in mm

Typical temporal profile

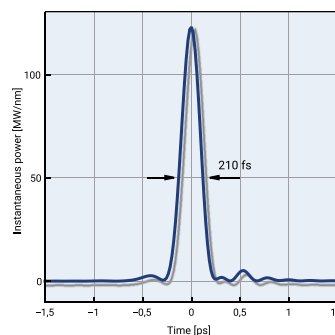

Typical spectral profile

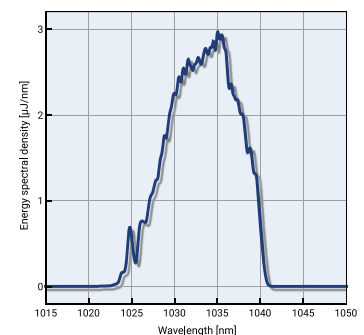

Typical beam profile

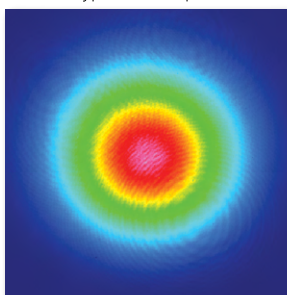

Typical power stability

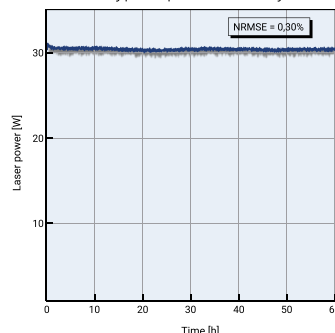

Pulse energy vs. repetition rate

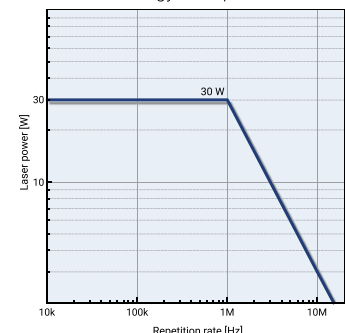

All specifications are subject to change without prior notice due to continuous improvements.